

Parts

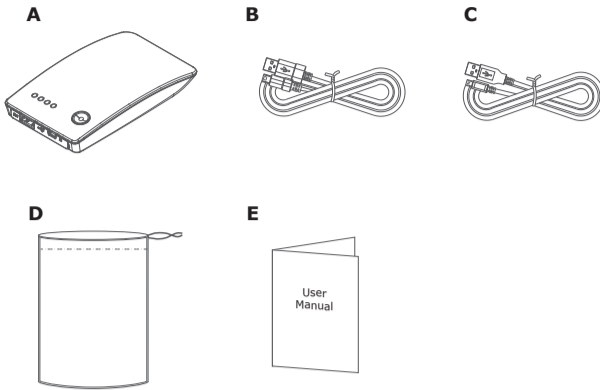

Introduction:

Thank you for purchasing the Power Fort 10Whrs. This User's Manual provides operations for Power Fort which is a rechargeable battery pack with a 5V USB output ideal for powering and charging iPod, cell phones, MP3/MP4 players, GPS, Bluetooth and portable gaming systems via USB charging cable.

Package Contents:

Ensure the following contents are included in the package. If any item is damaged or missing, please contact the store where it was purchased.

- A. Power Fort 10Whrs x 1
- B. USB Cable (Standard to mini) x 1
- C. USB Cable (Standard to micro) x 1
- D. Carry Bag x 1
- E. User's Manual

Note: For Advance Version, package will include an universal AC USB charger x1 and Car USB charger x1.

Power Fort Overview

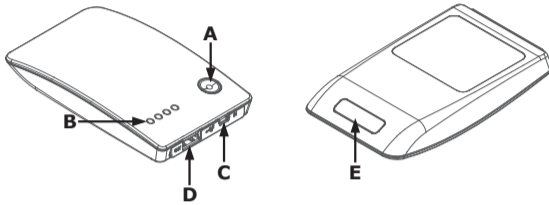

Product Overview:

- A. Power Button
- B. LED Capacity Indications
- C. Charge Input Port
- D. 5V USB Output Port
- E. Flashlight

Charging Power Fort

Charging Devices

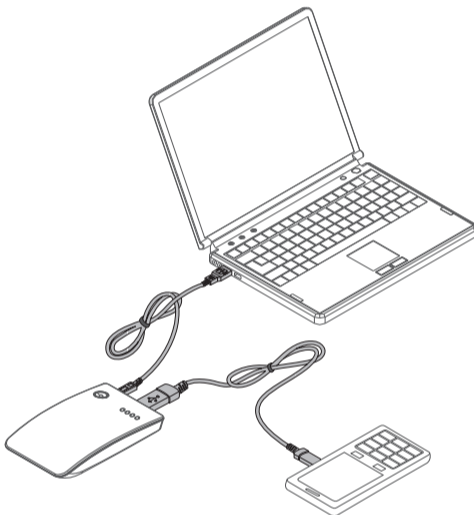

Installation Guide

Charging Power Fort

Always charge your Power Fort 10Whrs the first time for a full 8 hours before regular use. After the initial charge, normal charging will only take 3-4hours.

- A. Insert the tip of the USB cable into the input port of the Power Fort 10Whrs.
- B. Insert the end of USB cable into your notebook, desktop USB port, or anykind of USB charger.
- C. When All 4 LED light remains on for 10 seconds, your Power Fort is fully charged.
- D. The capacity indications will be turned off after fully charged.

Charging Devices

Check for voltage compatibility with your hand-held device first.

- A. Insert the tip of the USB cable into the output port of the Power Fort 10Whrs.
- B. Insert the end of USB cable into your hand-held device.
- C. Push the power button.

Flashlight Mode: Push the power button twice continuously.

Specification

Power Capacity	2700 mAh / 10Whrs
Input	5V / 1A
Output	5V / 1A
Battery type	Lithium-polymer
Recharging time	3~4 hours
Dimension	11x6.4x1.2 cm 4.3x2.5x0.5 inch
Weight	102 g (3.6 Oz)
Operating Temperature	-10~50°C (14~122°F)
Protection	Over Charging Protection Over Discharging Protection Over Current Protection Short Circuit Protection Over temperature Protection

Safety Precautions:

Please read the following carefully before using Power Fort 10Whrs. Incorrect use or incompatibility with your device may result in reduced battery performance or damage to your device.

- Check device voltage for compatibility with this product.
- Do not attempt to disassemble product.
- Store and operate between -10~50°C (14~122°F).
- Do not allow this product to have contact with liquids.
- Do not place this product near a heat source or flame or it may explode.
- Do not throw or shake the power pack.
- Do not operate the power pack if it has been subjected to shock damaged.
- Do not crush or puncture the battery.
- Recharge the power pack every 3 months when not use. Use soft cloth to clean the exterior. Do not use harsh chemicals or strong cleaning solvents.
- The battery life will be cut down to 85% of original capacity after 500 times using.

Charging Power Fort

Flash	Light On	Charging Capacity
LED 1		Less than 15%
LED 2	LED 1	15%~45%
LED 3	LED 2	45%~70%
LED 4	LED 3	70%~95%

Note: When Power Fort is fully recharged, all 4 LEDs light on 10 seconds then turn off.

Charging Devices

Flash	Remaining Capacity
LED 1,2,3,4	100%~85%
LED 1,2,3	85%~55%
LED 1,2	55%~25%
LED 1	Less than 25%

Note: Press button once for showing battery capacity. LED indication will be power off after 5 seconds automatically.

Choiix inc. Cooler Master Group

8F., No.788-1, Chung-Cheng Rd.,
Chung-Ho City, Taipei County, Taiwan, R.O.C
Tel: +8862-32340588 Fax: + 8862-32340555
e-mail: grooving@choiix.com
http: //www.choiix.com

Warranty Information

© Choiix guarantees this device to be free of defects in material and workmanship, and provides a 2-year hardware limited warranty (does not include battery) for the Power Fort on the date of purchase. Please keep your receipt in a safe place.

- © The warranty applies to the Power Fort 10Whrs, and does not include battery and accessories.
- © The warranty applies to damages caused through normal use and is void if it is determined that the device was damaged because of abuse, iteration, misuse, negligence, incorrect voltage supply, air/water pollution, accidents and natural disasters.